

# MAINTENANCE & DISMOUNTING

**BEFORE DOING ANY MAINTENANCE OR DISMOUNTING AN ACCESSORY, REFER TO THE SAFETY PRECAUTIONS.**

## **MAINTENANCE**

- Grease the wheel axles after every eight hours of use.
- Chain: do not lubricate when used in dusty conditions. After use, wash clean and lubricate.
- Frequently clean the interior and exterior of hood, dirt, mud, ice, etc, accumulation adds weight on the brush and could result in premature wear of brush.
- Check mounting bolts at frequent intervals for proper tightness to be sure equipment is in safe working conditions.
- Apply oil at all pivot points.
- Inspect the air filter on the vehicle and accessory every day. Clean it or replace it when necessary. Change the oil more often when working in dusty conditions. See the owner's manual for the vehicle or for the accessory.



## **CAUTION**



**Never use the Rotary Broom without the belt guard.**

## **BELT REPLACEMENT:**

For belt part numbers, refer to parts breakdown section for parts identification.

- Remove the two bolts (item 1) and the flat washers.
- Remove the belt guard (item 2).
- Replace the belt (item 3).
- Engage the accessory.
- Make sure the pulleys are well aligned.
- Engage and reinstall the belt guard.

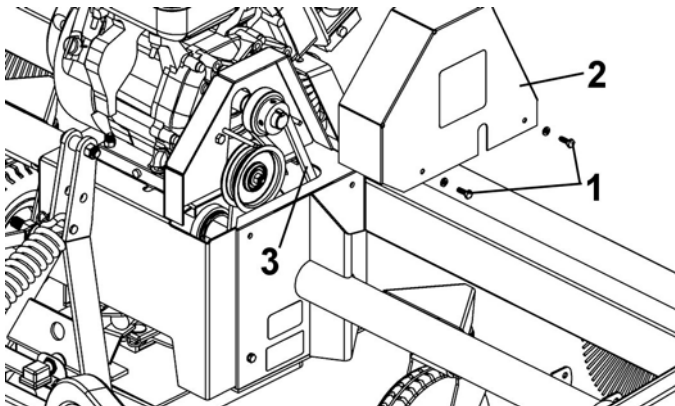

## **BRUSH REPLACEMENT:**

See parts breakdown section for parts identification.

- Lower the chain idler sprocket.
- Remove the chain by removing the connection link.
- Remove the bolts from both flangettes that holds the brush shaft.
- Remove the brush shaft from the broom frame.
- Remove the push plate that holds the brushes.
- Remove all the brushes that are worn out.
- Reinstall the brushes (a flat brush at each end) one at a time by rotating each section 1/4 turn from the other (always rotate in the same direction).
- Install the new brushes by reversing the procedure.

## **VERY IMPORTANT:**

**Reinstall the connecting link (item 1) in the same way as shown in the drawing.**

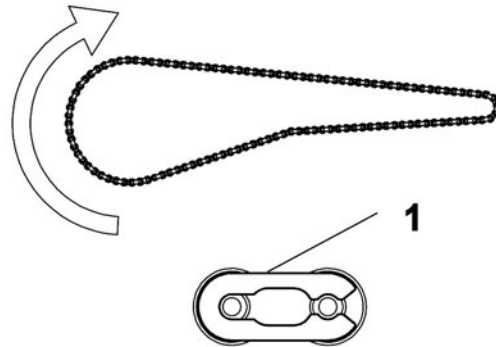

## MAINTENANCE & DISMOUNTING

### DISMOUNTING

- a) Select a flat horizontal surface, set parking brake, stop the engine, and remove the ignition key to prevent accidental starting.
- b) Straighten the broom perpendicular with the vehicle.
- c) Activate the parking stands toward the ground. Make sure the brush bristles never touch the ground.
- d) Lower the broom to the ground.
- e) Unhook the turnbuckles from the front of the vehicle, the hook from the winch and the hitch from the rear of the vehicle.
- f) Disconnect the wires.
- g) Remove the vehicle.

### END OF SEASON STORAGE

- a) Clean the broom and inside of the hood and paint all the parts where the paint has worn off.
- b) Take note of the replacement parts needed for next season.
- c) Lubricate all grease fittings and all moving parts.
- d) Store broom on parking stands on a flat horizontal surface. Make sure the brush bristles never touch the ground.
- e) If brush bristles are exposed to direct sunlight, protect the bristles with a tarp.
- f) Store the broom in a dry place.