

BELT REPLACEMENT

BELT REPLACEMENT:

For belt part numbers, refer to snowblower parts breakdown section for parts identification
Snowblower must be detached & disconnected from the A.T.V. to replace belts.

V-Belt:

- a) Remove the belt guard (item 1)
- b) Remove the 7/16 x 5 1/2" hex bolt (item 2) from the clutch support.
- c) Disconnect the wire from electric clutch.
- d) Remove the gas tank from the support (Put on the ground to avoid any spills).
- e) Turn the snowblower face down (engine on top).
- f) Remove the six nuts (item 3) and bolts from the reduction plate (item 4).
- g) Remove the reduction plate.
- h) Unhook the spring (item 5) from the slot on the tension arm (item 6) and remove the tension arm.
- i) Replace the belt.
- j) Re-install parts by repeating steps backwards.

Timing Belt:

- a) Remove the gas tank from the support. (Put on the ground to avoid any spills).
- b) Turn the snowblower face down (engine on top).
- c) Loosen slightly the four nuts (item 7) and the two nuts (item 8) needed to apply tension to the belt.
- d) Remove the six nuts (item 3) and bolts from the reduction plate (item 4)
- e) Remove the reduction plate
- f) Unhook the spring (item 5) from the slot on the tension arm (item 6) and remove the tension arm.
- g) Remove the V-belt.
- h) Replace the timing belt.

IMPORTANT:

Make sure the notches of the belt are well inserted into the those of the pulley. See belt adjustment section.

- i) Re-install parts by repeating steps backwards.
- j) Make sure to replace and realign the V-belt on the V-pulley.
- k) Make sure the spring is well installed in the slot on the tension arm.

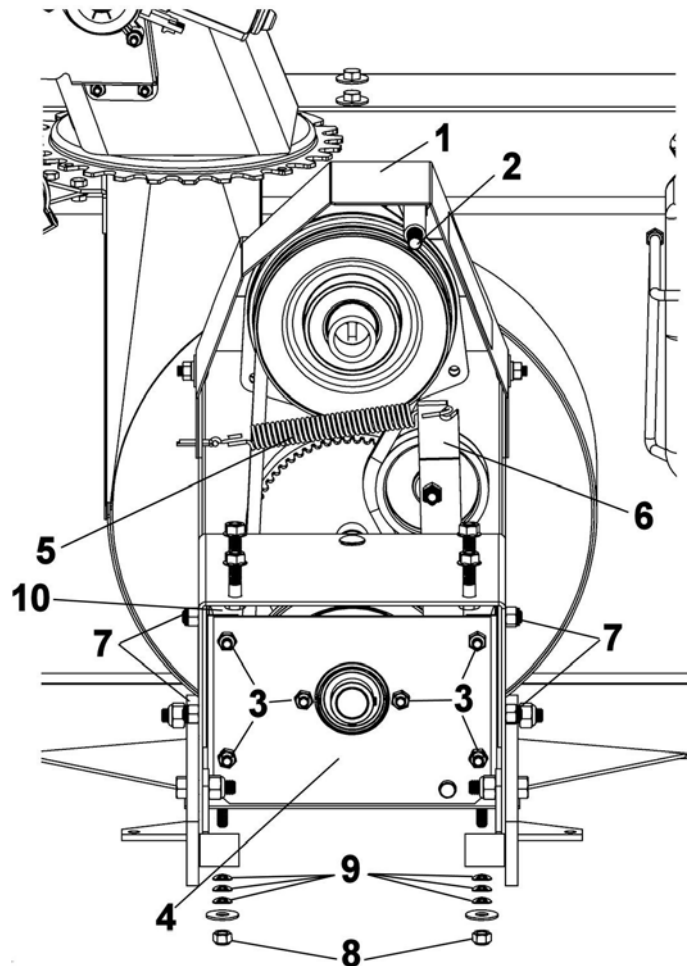

BELT ADJUSTMENTS



CAUTION



Never use the snowblower without the belt guard.

TIMING BELT ADJUSTMENT: (see following page for a good or improper pulley adjustment)

- a) Remove the belt guard (item 1) to better see the belt alignment
- b) Unhook the spring (item 5) to facilitate the rotation of the fan.
- c) Slightly loosen the four nuts (item 7).
- d) Tighten the two nuts (item 8) (needed to apply tension to the belt) until the three spring washers (item 9) are completely compressed. To have the right tension there should be a 1/32"-1/16" maximum deflection on the belt as shown.
- e) Retighten the four nuts (item 7).
- f) Turn the fan by hand a few turns and **make sure the timing belt is well engaged on the sprocket.**

If the belt is not well engaged,

- g) Loosen slightly the nuts (item 7) and re-align the pulleys by adjusting the angle of the reduction box (item 10) using the play of the bolt holes as shown on following page.
- h) Retighten the four nuts.
- i) Reinstall the spring (item 5) and the belt guard (item 1).

IMPORTANT: After installing the snowblower on the ATV, let snowblower run for a minute, turn everything off.

- j) Remove the belt guard and check the belt alignment et repeat the steps if the belt is not well aligned.
- k) Reinstall the belt guard.

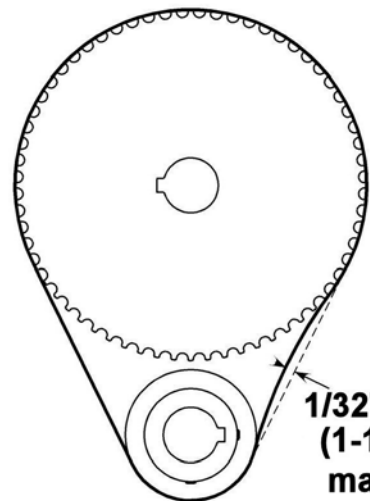
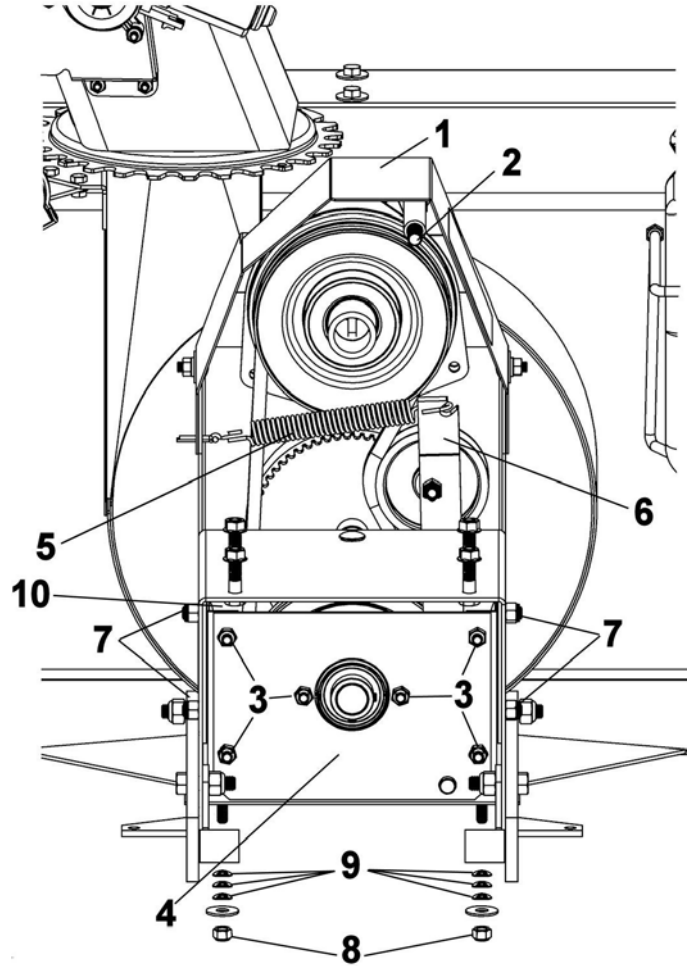

**1/32" - 1/16"
(1-1.5 mm)
maximum**

Deflection on the belt

BELT ADJUSTMENTS



CAUTION



Never use the snowblower without the belt guard.

IMPORTANT:

The following figures (side views) show a good or improper adjustment of the pulleys in the reduction box (item 10).

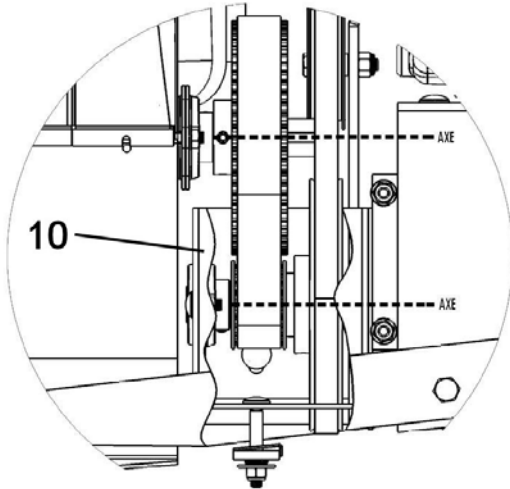

Good adjustment: The pulleys are well aligned and the timing belt stays completely engaged on the sprocket.

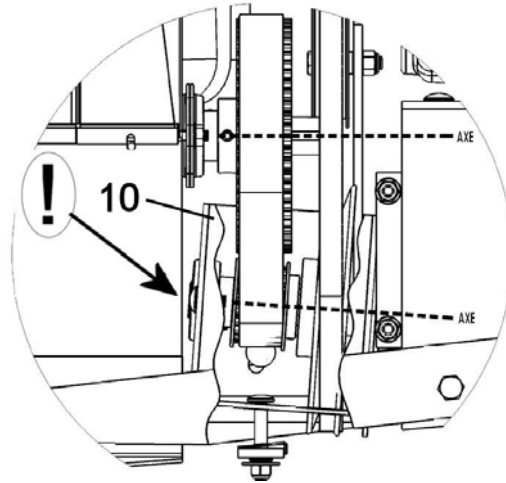

Improper adjustment: The pulleys are not well aligned and the timing belt does not stay completely engaged on the sprocket, you have to realign the pulleys by adjusting the angle of the reduction box.